

model no / **CBH**

Ball Bearing Hinge

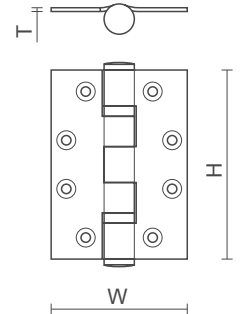

- **Hinge Grade:** Grade 13
 - **Features:** Load bearing capacity upto 120Kg and durability tested to over 200 000 cycles
 - **Finishes:** SSS: Satin Stainless Steel
PSS: Polished Stainless Steel
 - ***Independent Testing:** Tested to EN1935
 - ***Fire Rating:** Tested to EN1634-1
- CBH.100 : H 76 x W 52 x T 2
 - *CBH.102 : H 102 x W 76 x T 3
 - CBH.103 : H 102 x W 89 x T 3
 - *CBH.104 : H 102 x W 102 x T 3
 - CBH.105 : H 114 x W 102 x T 3.4
 - CBH.106 : H 114 x W 114 x T 3.5



model no / **CRCH**

Radius Cornered Ball Bearing Hinge



- **Finishes:** SSS: Satin Stainless Steel
PSS: Polished Stainless Steel

- CRCH.1 : 102 x 76 x 3
- CRCH.2 : 100 x 100 x 3

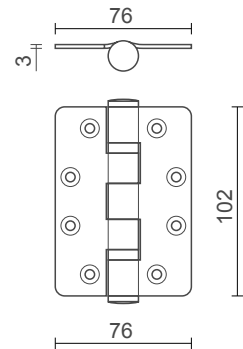

model no / **CPH**

Parliament Hinge



- **Finishes:** PCP: Polished Chrome Plate
PB: Polished Brass
SCP: Satin Chrome Plate

- CPH.30 : 100 x W1: 75 x W2: 100
- CPH.31 : 100 x W1: 75 x W2: 125
- CPH.32 : 100 x W1: 100 x W2: 150

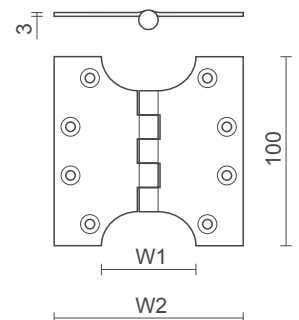

model no / **CRH**

Rising and Falling Hinge



- **Finishes:** SSS: Satin Stainless Steel
PSS: Polished Stainless Steel

- CRH.19 : Left Hand Rising Butt Hinge, 102 x 76 x 3
- CRH.20 : Right Hand Rising Butt Hinge, 102 x 76 x 3
- CFH.21 : Left Hand Falling Butt Hinge, 102 x 76 x 3
- CFH.22 : Right Hand Falling Butt Hinge, 102 x 76 x 3

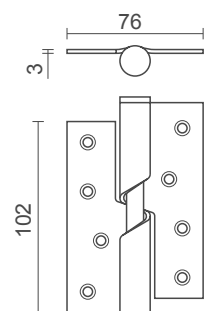

model no / **CSCH 25**

Swing Clear Ball Bearing Hinge



- **Finishes:** SSS: Satin Stainless Steel
 PSS: Polished Stainless Steel
 PCP: Polished Chrome Plate
 PB: Polished Brass

- CSCH.25 : 102 x 3

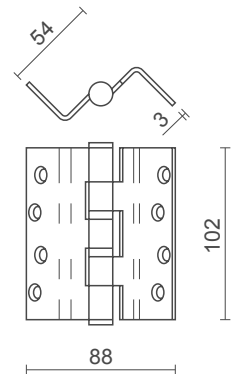

model no / **CCH**

Concealed Hinge



- **Finishes:** Zinc diecast
 SNP: Satin Nickel Plate
 PB: Polished Brass

- **Note:** Not suitable for fire doors

- CCH212 : 95mm (for doors 28-34mm)
- CCH216 : 117mm (for doors 35-38mm)

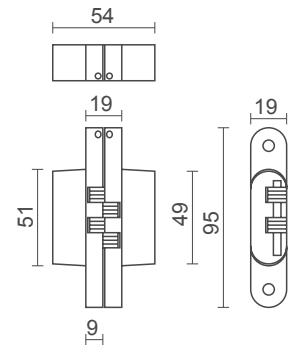

model no / **CSA**

Single Action Spring Hinge



- **Features:** Suitable for doors up to 4" wide x 8" high by max 80kgs
- **Fire Rating :** UL listed & EN1634-1 tested
- **Finishes :** US26D (SCP: Satin Chrome Plate) : standard
 US32S(SSS: Satin Stainless Steel) : to order

- CSA103 : 4.5" x 4" (114x101mm)

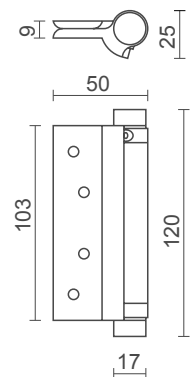

model no / **CDA**

Double Action Spring Hinge



- **Fire Rating :** Not suitable for use on fire doors
- **Finishe :** SSS: Satin Stainless Steel
 PSS: Polished Stainless Steel
 PB: Polished Brass

- CDA101 : 4" for doors max 22kg
- CDA102 : 5" for doors max 27kg
- CDA103 : 6" for doors max 40kg

